



EYEBEAM-SC

REVISION: A

EFFECTIVE: 9/2013

EYEBEAM-SC™

LED DOWNLIGHT FIXTURES FOR ELEVATORS

DOWNLIGHT



**PATENTED
PRODUCT**

**OTHER PATENTS
PENDING**

eyeBEAM™ SC Spring Clip

EYEBEAM-SC by Man-D-Tec®

PATENTED, LOW PROFILE LED LIGHTING SYSTEM, DESIGNED SPECIFICALLY FOR ELEVATOR APPLICATIONS.

Warm white 4 watt LED output that produces 209 lumens per fixture. Systems include a power supply with pre-installed dimmer control and prewired harnesses for easy installation. The low profile fixture height allows the fixtures to be installed in elevator ceilings with low clearance. Our Smooth Beam™ technology produces a wide angle light output with even lighting (eliminates pixilation).

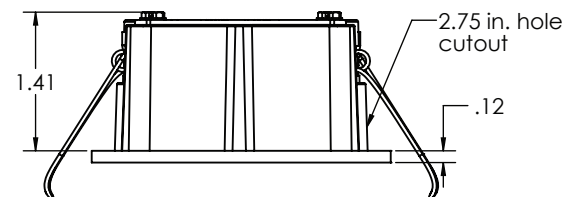

SIDE VIEW

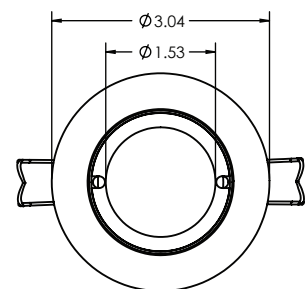

FRONT VIEW



448D
ELEVATOR CONTROL,
ELEVATOR ACCESSORY
E329545



1.800.944.6263

WWW.MANDTEC.COM

EYEBEAM-SC

REVISION: A

EFFECTIVE: 9/2013

EYEBEAM-SC™
SPECIFICATIONSFixture
(EYEBEAM-SC)**MATERIAL** Aluminum Die Casting

DIMENSIONS 1.41" Overall Height
 2.75" Cutout Hole
 3.04" Overall Diameter
Uses Same Hole Cutout Size as Our H-DL™ Fixtures.



44BD
 ELEVATOR CONTROL,
 ELEVATOR ACCESSORY
 E329545

MOUNTING Spring Clips

FINISHES **Black** Powder Coat **STANDARD**
Brushed #4 Silver Brushed Finish (Option)
Polished High Luster #8 Mirror Finish (Option)
White Powder Coat (Option)
Gold Powder Coat (Option)

OUTPUT **209 Lumens** Warm White (Approx 2,923k)
As per LM-79 report by an iAS Accredited Laboratory
 *Also available in NEUTRAL WHITE (Approx 4,100k)



LED **Wattage** 4 Watts of LEDs Per Fixture
Reflector SmoothBeam™ Technology - Wide Angle
SAVE EVEN MORE! Pre-Installed Dimmer Control is Included!
Adjust from 1 Watt to 4 Watts of LED Output Per Fixture

LUMINOUS EFFICACY **52.2** Lumens Per Watt (Warm White)

Power
Supply**MATERIAL** .060 Aluminum**DIMMER** INCLUDED**VOLTAGE** Input: 115 VAC (220VAC Also Available)

44BD
 ELEVATOR CONTROL,
 ELEVATOR ACCESSORY
 E329545

Wiring

SECONDARY (OUTPUT) Pre-harnessed with quick connects at power supply and at each fixture

Emergency
(Optional)

ELS®-SB™
 Powers (2) two EyeBeam-SC LED fixtures to meet ANSI 17.1 & ASME 17.3-2008 Elevator Code and mounts in EyeBeam power Supply.

EXCEEDS A17.3 4-HOUR RUNTIME CODE REQUIREMENT FOR EMERGENCY LIGHTING.**MAN-D-TEC, INC.**

8175 E. PARADISE LANE
 SCOTTSDALE, AZ 85260

P. 480.998.0325
F. 480.998.0318

1.800.944.6263

WWW.MANDTEC.COM